

technical specifications

finishing: melamine · mélaminé plaqué · nobilitato melaminico

panels: Sherwood · Sound Wood · Lamella



oak rock white · rovere rock bianco



elm tafira · olmo tafira



ash tree bahia · frassino bahia



oak bruges · rovere bruges



walnut pireus · noce pireus



walnut athens · noce athens



white · bianco

The colour card shown on this page is purely for information purposes; please request samples.

Please contact CBI Europe's Technical Office for special colour requirements which will be supplied only for orders of at least 800 sq.m. Wood system accessories are finished in aluminium or wood.

Le cartelle colori riportate in questa pagina s'intendono puramente indicative, e si raccomanda la richiesta di campionatura. Per colori non presenti in cartella e soltanto per forniture di colore pari o superiori a 800 m², contattare l'ufficio tecnico CBI Europe. Gli accessori del sistema Wood possono essere in finitura alluminio o legno.

LAMELLA

MDF high density · MDF haute densité · MDF alta densità

dimensions:

· 100/150/200X14 mm

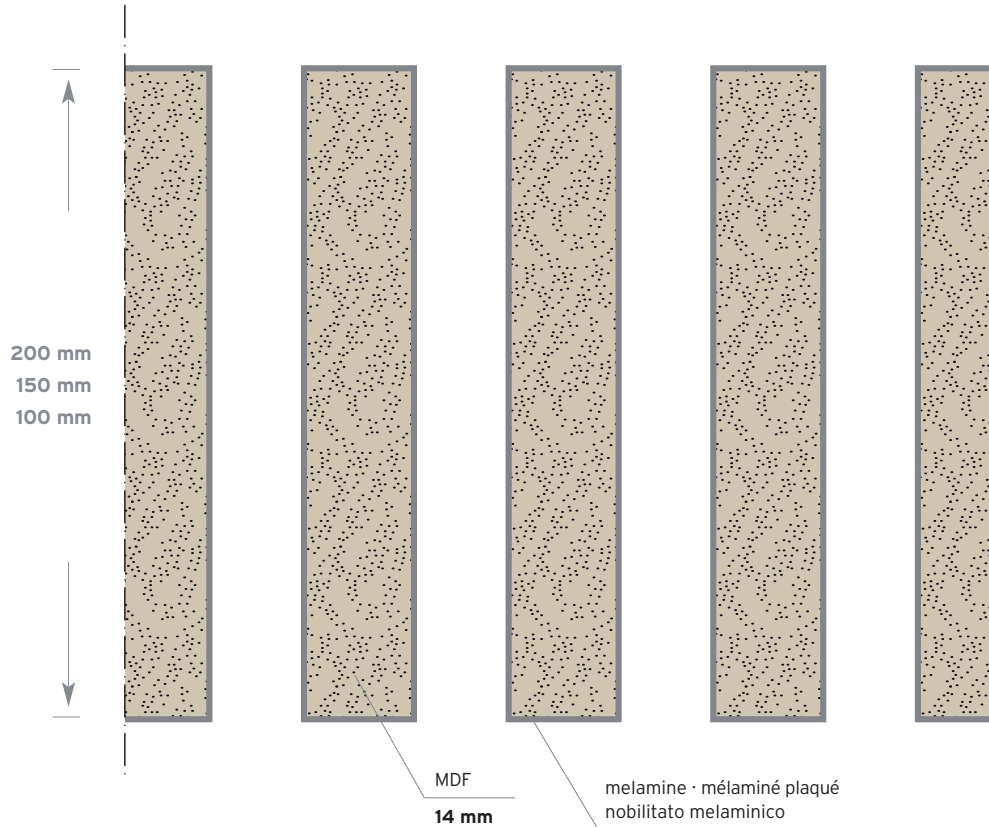

MDF HIGH DENSITY · MDF HAUTE DENSITÉ · MDF ALTA DENSITÀ

 Internal bond · Résistance au déchirement · Resistenza allo strappo	EN 319	0,65 / 1,1 N/mm ²
C.R.F.	EN 310	22 / 35,1 N/mm ²
M.O.E.	EN 310	2500 3180 N/mm ²
Thickness swelling 24H (max) · Gonflement en épaisseur 24h (max) · Rigonfiamento 24H (max)	EN 317	15,0 / 12,3 %
Surface soundness · Déchirement superficiel · Strappo superficiale	EN 311	1,2 / 1,8 N/mm ²
MDF Density · Densité · Densità	EN 323	780 Kg/m ³ +/- 5%
Thickness Tolerance · Tolérance d'épaisseur · Tolleranza di spessore	EN 324-1	+/- 0,2 mm
Length and width tolerance · Tol. longueur et largeur · Toll. lunghezza e larghezza	EN 324-1	+/- 0,3 mm
Squareness · Équerrage · Squadro	EN 324-2	+/- 0,3 mm
Moisture content · Humidité · Umidità	EN 322	4% - 11%
Grit content · Contenu en silice · Contenuto in silice	ISO 3340	< 0,05%
Formaldehyde · Formaldéhyde · Formaldeide	EN 120	< 9 mg / 100 g
Fire reaction class · Classe de réaction au feu · Classe di reazione al fuoco		B s ₂ d ₀



WOOD LAMELLA 300 SYSTEM

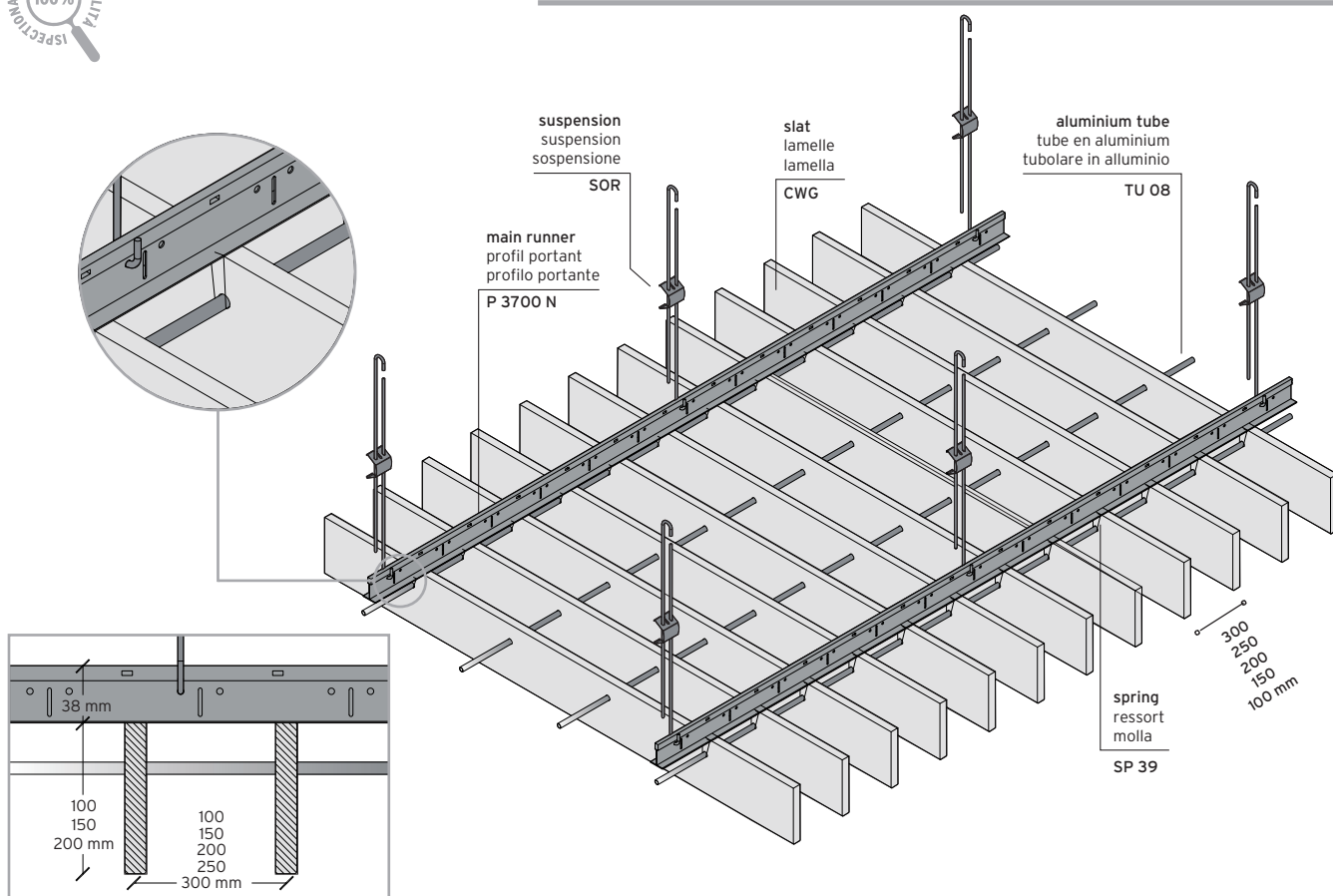

SLAT _ LAMELLE _ LAMELLA

CWG

melamine MDF slat, ABS edge, thickness 14 mm
 lamelle en mélaminé plaqué, bord en ABS, épaisseur 14 mm
 lamella in MDF nobilitato melaminico, bordo in ABS, spessore 14 mm

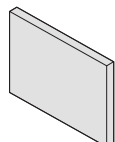

size _ dimensioni
 200 150 100

H100/150/200 mm x L1800 mm max or H on request
 pitch 100/50 mm or on request

> cf. finishing
 > cf. finitions
 > cf. finiture

STRUCTURE _ STRUCTURE _ STRUTTURA

system detail _ details du système _ dettaglio sistema

system components _ éléments du système _ elementi del sistema

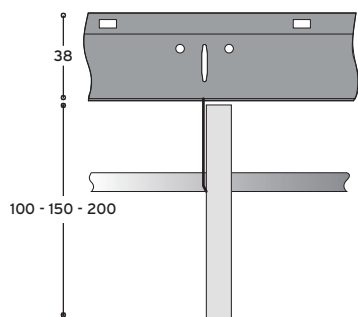

P 3700 N

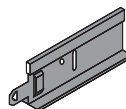

main runner _ profil portant
 profilo portante

size _ dimensioni incidence _ incidenza
 24x38x3700 mm 1.67 ml/mq

TU 08

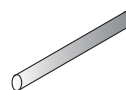

aluminium tube _ tube en aluminium
 tubolare in alluminio

size _ dimensioni
 Ø 8 mm

SP 39



spring _ ressort _ molla

incidence _ incidenza
 18 pcs/mq

SOR



suspension _ suspension _ sospensione

incidence _ incidenza
 2 pcs/mq

Technical dates / Aspects of performance value (UNI 13964 - 2005)
 Dati tecnici / Aspetti pertinenti a valori prestazionali (UNI 13964 - 2005)

FIRE REACTION _ REAZIONE AL FUOCO
 (Under structure) Class A1 DM 10/03/05 DEC. 2000/147/CE

MECHANICAL RESISTANCE _ RESISTENZA MECCANICA
 (Under structure) 269.5 N/m² Normal break load/Carico normale di rottura
 (Under structure) 107.8 N/m² Normal operating load/Carico normale di esercizio

DURABILITY _ DURABILITÀ
 Protection against corrosion _ Protezione contro la corrosione: EN 10327